



# Notice of variation and consolidation with introductory note

**The Environmental Permitting (England & Wales) Regulations 2016**

---

Bucks Recycling Limited

Hangar 5  
Westcott Venture Park  
Westcott  
Buckinghamshire  
HP18 0XB

**Variation application number**

EPR/BB3634RA/V004

**Permit number**

EPR/BB3634RA

# Hangar 5

## Permit number EPR/BB3634RA

### Introductory note

#### This introductory note does not form a part of the notice

Under the Environmental Permitting (England & Wales) Regulations 2016 (schedule 5, part 1, paragraph 19) a variation may comprise a consolidated permit reflecting the variations and a notice specifying the variations included in that consolidated permit.

Schedule 1 of the notice specifies the conditions that have been varied and schedule 2 comprises a consolidated permit which reflects the variations being made. All the conditions of the permit have been varied and are subject to the right of appeal.

This variation converts an SR2008 No.3 standard rules permit to a bespoke permit to operate a household, commercial and industrial waste transfer station with treatment and extends the permit boundary. As part of the varied operations, treatment of waste will be undertaken outside the building including the processing of timber and processing of recovered hardcore and rubble. An additional treatment activity includes the drying of residual waste from the recycling operation in sealed drying containers for use in an Energy from Waste facility.

The schedules specify the changes made to the permit.

The status log of a permit sets out the permitting history, including any changes to the permit reference number.

Status log of the permit		
Description	Date	Comments
Permit determined EPR/BB3634RA	20/02/12	Permit issued to Bucks Recycling Limited.
Variation determined EPR/BB3634RAV002	12/05/15	Variation to update the registered office address and extend the site boundary.
Variation determined EPR/BB3634RAV003	21/09/16	Variation to extend the site boundary.
Application EPR/BB3634RA/V004 (variation and consolidation)	Duly made 18/04/19	Application to vary and update the permit to modern conditions.
Response to Schedule 5 notice issued 27/06/19	19/07/19	Noise modelling; Further evidence of technical competence.
	23/07/19	Dust management plan; Revised Fire prevention plan.
	30/08/19	Further evidence of technical competence; Technical specification for mobile plant; Revised site plan; Ambient air quality report; Revised Fire prevention plan; Revised dust management plan.
Response to Schedule 5 notice issued 17/09/19	07/10/19	Revised site plan showing new boundary;

<b>Status log of the permit</b>		
<b>Description</b>	<b>Date</b>	<b>Comments</b>
		Confirmation of waste types subject to the drying process; Confirmation that there are no emissions from the sealed drying containers; Consideration of the R1 recovery operation; Explanation of how the site will interact with the local authority permit; Confirmation of the maintenance protocols for the 3 metre bund.
Additional information received	10/10/19	Confirmation that the Energy from Waste facility is a co-incineration plant.
Additional information received	31/01/20	Revised site plan; Revised Fire Prevention Plan.
Variation determined EPR/BB3634RA	11/02/20	Varied permit issued.

End of introductory note

# Notice of variation and consolidation

## The Environmental Permitting (England and Wales) Regulations 2016

The Environment Agency in exercise of its powers under regulation 20 of the Environmental Permitting (England and Wales) Regulations 2016 varies

**Permit number**

**EPR/BB3634RA**

**Issued to**

**Bucks Recycling Limited** ("the operator")

whose registered office is

**Building 214 Westcott Venture Park  
Westcott  
Aylesbury  
Buckinghamshire  
HP18 0XB**

company registration number 03393275

to operate a regulated facility at

**Hangar 5  
Westcott Venture Park  
Westcott  
Buckinghamshire  
HP18 0XB**

to the extent set out in the schedules.

The notice shall take effect from 11/02/2020

<b>Name</b>	<b>Date</b>
<b>Helen Smith</b>	<b>11/02/2020</b>

Authorised on behalf of the Environment Agency

## **Schedule 1**

All conditions have been varied by the consolidated permit as a result of the application made by the operator.

## **Schedule 2 – consolidated permit**

Consolidated permit issued as a separate document.

# Permit

## The Environmental Permitting (England and Wales) Regulations 2016

### Permit number

**EPR/BB3634RA**

This is the consolidated permit referred to in the variation and consolidation notice for application EPR/BB3634RA/V004 authorising,

**Bucks Recycling Limited** ("the operator"),

whose registered office is

**Building 214 Westcott Venture Park**

**Westcott**

**Aylesbury**

**Buckinghamshire**

**HP18 0XB**

company registration number 03393275

to operate waste operations at

**Hangar 5**

**Westcott Venture Park**

**Westcott**

**Buckinghamshire**

**HP18 0XB**

to the extent authorised by and subject to the conditions of this permit.

Name	Date
Helen Smith	11/02/2020

Authorised on behalf of the Environment Agency

# Conditions

## 1 Management

### 1.1 General management

1.1.1 The operator shall manage and operate the activities:

- (a) in accordance with a written management system that identifies and minimises risks of pollution, including those arising from operations, maintenance, accidents, incidents, non-conformances, closure and those drawn to the attention of the operator as a result of complaints; and
- (b) using sufficient competent persons and resources.

1.1.2 Records demonstrating compliance with condition 1.1.1 shall be maintained.

1.1.3 Any person having duties that are or may be affected by the matters set out in this permit shall have convenient access to a copy of it kept at or near the place where those duties are carried out.

1.1.4 The operator shall comply with the requirements of an approved competence scheme.

### 1.2 Avoidance, recovery and disposal of wastes produced by the activities

1.2.1 The operator shall take appropriate measures to ensure that:

- (a) the waste hierarchy referred to in Article 4 of the Waste Framework Directive is applied to the generation of waste by the activities; and
- (b) any waste generated by the activities is treated in accordance with the waste hierarchy referred to in Article 4 of the Waste Framework Directive; and
- (c) where disposal is necessary, this is undertaken in a manner which minimises its impact on the environment.

1.2.2 The operator shall review and record at least every four years whether changes to those measures should be made and take any further appropriate measures identified by a review.

## 2 Operations

### 2.1 Permitted activities

2.1.1 The operator is only authorised to carry out the activities specified in schedule 1 table S1.1 (the "activities").

### 2.2 The site

2.2.1 The activities shall not extend beyond the site, being the land shown edged in red on the site plan at schedule 7 to this permit.

### 2.3 Operating techniques

2.3.1 The activities shall, subject to the conditions of this permit, be operated using the techniques and in the manner described in the documentation specified in schedule 1, table S1.2, unless otherwise agreed in writing by the Environment Agency.

- (a) if notified by the Environment Agency, submit to the Environment Agency for approval within the period specified, a pests management plan which identifies and minimises risks of pollution, hazard or annoyance from pests;
- (b) implement the pests management plan, from the date of approval, unless otherwise agreed in writing by the Environment Agency.

### **3.5 Fire prevention**

- 3.5.1 The operator shall take all appropriate measures to prevent fires on site and minimise the risk of pollution from them including, but not limited to, those specified in any approved fire prevention plan.

## **4 Information**

### **4.1 Records**

- 4.1.1 All records required to be made by this permit shall:

- (a) be legible;
- (b) be made as soon as reasonably practicable;
- (c) if amended, be amended in such a way that the original and any subsequent amendments remain legible, or are capable of retrieval; and
- (d) be retained, unless otherwise agreed in writing by the Environment Agency, for at least 6 years from the date when the records were made, or in the case of the following records until permit surrender:
  - (i) off-site environmental effects; and
  - (ii) matters which affect the condition of the land and groundwater.

- 4.1.2 The operator shall keep on site all records, plans and the management system required to be maintained by this permit, unless otherwise agreed in writing by the Environment Agency.

### **4.2 Reporting**

- 4.2.1 The operator shall send all reports and notifications required by the permit to the Environment Agency using the contact details supplied in writing by the Environment Agency.

- 4.2.2 Within one month of the end of each quarter, the operator shall submit to the Environment Agency using the form made available for the purpose, the information specified on the form relating to the site and the waste accepted and removed from it during the previous quarter.

### **4.3 Notifications**

- 4.3.1 The Environment Agency shall be notified without delay following the detection of:

- (a) any malfunction, breakdown or failure of equipment or techniques, accident, or emission of a substance not controlled by an emission limit which has caused, is causing or may cause significant pollution;
- (b) the breach of a limit specified in the permit; or
- (c) any significant adverse environmental effects.

- 4.3.2 Any information provided under condition 4.3.1 shall be confirmed by sending the information listed in schedule 5 to this permit within the time period specified in that schedule.

4.3.3 Where the Environment Agency has requested in writing that it shall be notified when the operator is to undertake monitoring and/or spot sampling, the operator shall inform the Environment Agency when the relevant monitoring and/or spot sampling is to take place. The operator shall provide this information to the Environment Agency at least 14 days before the date the monitoring is to be undertaken.

4.3.4 The Environment Agency shall be notified within 14 days of the occurrence of the following matters, except where such disclosure is prohibited by Stock Exchange rules:

Where the operator is a registered company:

- (a) any change in the operator's trading name, registered name or registered office address; and
- (b) any steps taken with a view to the operator going into administration, entering into a company voluntary arrangement or being wound up.

Where the operator is a corporate body other than a registered company:

- (a) any change in the operator's name or address; and
- (b) any steps taken with a view to the dissolution of the operator.

In any other case:

- (a) the death of any of the named operators (where the operator consists of more than one named individual);
- (b) any change in the operator's name(s) or address(es); and
- (c) any steps taken with a view to the operator, or any one of them, going into bankruptcy, entering into a composition or arrangement with creditors, or, in the case of them being in a partnership, dissolving the partnership.

4.3.5 Where the operator proposes to make a change in the nature or functioning, or an extension of the activities, which may have consequences for the environment and the change is not otherwise the subject of an application for approval under the Regulations or this permit:

- (a) the Environment Agency shall be notified at least 14 days before making the change; and
- (b) the notification shall contain a description of the proposed change in operation.

## **4.4 Interpretation**

4.4.1 In this permit the expressions listed in schedule 6 shall have the meaning given in that schedule.

4.4.2 In this permit references to reports and notifications mean written reports and notifications, except where reference is made to notification being made "without delay", in which case it may be provided by telephone.

# Schedule 1 – Operations

Table S1.1 activities	
Description of activities for waste operations	Limits of activities
<p><u>Transfer Station</u></p> <p>R3: Recycling/reclamation of organic substances which are not used as solvents (including composting and other biological transformation processes)</p> <p>R4: Recycling/reclamation of metals and metal compounds</p> <p>R5: Recycling/reclamation of other inorganic materials</p> <p>R13: Storage of waste pending any of the operations numbered R1 to R12 (excluding temporary storage, pending collection, on the site where the waste is produced)</p> <p>D9: Physico-chemical treatment not specified elsewhere which results in final compounds or mixtures which are discarded by means of any of the operations numbered D1 to D12</p> <p>D14: Repackaging prior to submission to any of the operations numbered D1 to 13</p> <p>D15: Storage pending any of the operations numbered D1 to D14 (excluding temporary storage, pending collection, on the site where the waste is produced)</p>	<p>Physical treatment including manual and mechanical sorting/separation, screening, baling, shredding, crushing or compaction of non-hazardous waste for disposal (no more than 50 tonnes per day in total shall be treated under D9 activities on site) or recovery.</p> <p>Subject to any other requirements of this permit wastes shall be stored for no longer than 1 year prior to disposal or 3 years prior to recovery.</p> <p>Unless stored or treated outside as specified waste all waste shall be stored and treated on an impermeable surface with sealed drainage system.</p> <p>Specified waste shall be stored and treated on hard standing or on an impermeable surface with sealed drainage system.</p> <p>Waste types as specified in Table S2.1.</p>
<p><u>Pre-treatment of waste for incineration or co-incineration</u></p> <p>R3: Recycling/reclamation of organic substances which are not used as solvents (including composting and other biological transformation processes)</p> <p>R13: Storage of waste pending any of the operations numbered R1 to R12 (excluding temporary storage, pending collection, on the site where the waste is produced)</p> <p>D9: Physico-chemical treatment not specified elsewhere which results in final compounds or mixtures which are discarded by means of any of the operations numbered D1 to D12</p>	<p>Pre-treatment of waste for incineration or co-incineration consisting of drying of waste wood only for disposal (no more than 50 tonnes per day in total shall be treated under D9 activities on site) or recovery (no more than 75 tonnes per day).</p> <p>No treatment of hazardous waste shall be undertaken under this activity.</p> <p>Waste types as specified in Table S2.2.</p> <p>Subject to any other requirements of this permit wastes shall be stored for no longer than 1 year prior to disposal or 3 years prior to recovery.</p>

<b>Table S1.1 activities</b>	
<b>Description of activities for waste operations</b>	<b>Limits of activities</b>
D15: Storage pending any of the operations numbered D1 to D14 (excluding temporary storage, pending collection, on the site where the waste is produced) temporary storage, pending collection, on the site where the waste is produced)	<p>Unless stored or treated outside as specified waste all waste shall be stored and treated on an impermeable surface with sealed drainage system.</p> <p>Specified waste shall be stored and treated on hard standing or on an impermeable surface with sealed drainage system.</p>

<b>Table S1.2 Operating techniques</b>		
<b>Description</b>	<b>Parts</b>	<b>Date Received</b>
Response to Schedule 5 Notice dated 27/06/19	<p>Approved Fire Prevention Plan consisting of the following documents:</p> <ul style="list-style-type: none"> <li>- Fire Prevention Plan version 1.4.</li> <li>- Email dated 30/08/19 at 15:21 confirming that CCTV controlled by Bucks Recycling also covers all external areas.</li> </ul> <p>Approved Emissions Management Plan 'Dust &amp; Odour Management Plan', document reference EPR/BB3634RA/18.</p>	<p>31/01/20</p> <p>30/08/19</p> <p>03/09/19</p>

## Schedule 2 – Waste types

<b>Table S2.1 Permitted waste types and quantities for transfer station</b>	
<b>Maximum quantity</b>	The total quantity of waste accepted at the site for the waste transfer and treatment and the waste drying activity shall be less than 75,000 tonnes a year.
<b>Exclusions</b>	<b>Wastes having any of the following characteristics shall not be accepted:</b> <b>Consisting solely or mainly of dusts, powders or loose fibres.</b> <b>Wastes that are in a form which is either sludge or liquid.</b>
<b>Waste code</b>	<b>Description</b>
<b>01</b>	<b>Wastes resulting from exploration, mining, quarrying, and physical and chemical treatment of minerals</b>
<b>01 01</b>	<b>wastes from mineral excavation</b>
01 01 01	wastes from mineral metalliferous excavation
01 01 02	wastes from mineral non-metalliferous excavation
<b>01 03</b>	<b>wastes from physical and chemical processing of metalliferous minerals</b>
01 03 06	tailings other than those mentioned in 01 03 04 and 01 03 05
01 03 09	red mud from alumina production other than the wastes mentioned in 01 03 10
<b>01 04</b>	<b>wastes from physical and chemical processing of non-metalliferous minerals.</b>
01 04 08	waste gravel and crushed rocks other than those mentioned in 01 04 07
01 04 09	waste sand and clays
01 04 11	wastes from potash and rock salt processing other than those mentioned in 01 04 07
01 04 12	tailings and other wastes from washing and cleaning of minerals other than those mentioned in 01 04 07 and 01 04 11
01 04 13	wastes from stone cutting and sawing other than those mentioned in 01 04 07
<b>02</b>	<b>Wastes from agriculture, horticulture, aquaculture, forestry, hunting and fishing, food preparation and processing</b>
<b>02 01</b>	<b>wastes from agriculture, horticulture, aquaculture, forestry, hunting and fishing</b>
02 01 03	plant-tissue waste
02 01 04	waste plastics (except packaging)
02 01 07	wastes from forestry
02 01 10	waste metal
<b>02 02</b>	<b>wastes from the preparation and processing of meat, fish and other foods of animal origin</b>
02 02 03	materials unsuitable for consumption or processing
<b>02 03</b>	<b>wastes from fruit, vegetables, cereals, edible oils, cocoa, coffee, tea and tobacco preparation and processing; conserve production; yeast and yeast extract production, molasses preparation and fermentation</b>
02 03 04	materials unsuitable for consumption or processing
<b>02 04</b>	<b>wastes from sugar processing</b>
02 04 01	soil from cleaning and washing beet

<b>Table S2.1 Permitted waste types and quantities for transfer station</b>	
<b>Maximum quantity</b>	The total quantity of waste accepted at the site for the waste transfer and treatment and the waste drying activity shall be less than 75,000 tonnes a year.
<b>Exclusions</b>	Wastes having any of the following characteristics shall not be accepted: Consisting solely or mainly of dusts, powders or loose fibres. Wastes that are in a form which is either sludge or liquid.
<b>Waste code</b>	<b>Description</b>
02 04 02	off-specification calcium carbonate
<b>02 05</b>	<b>wastes from the dairy products industry</b>
02 05 01	materials unsuitable for consumption or processing
<b>02 06</b>	<b>wastes from the baking and confectionery industry</b>
02 06 01	materials unsuitable for consumption or processing
02 06 02	wastes from preserving agents
<b>02 07</b>	<b>wastes from the production of alcoholic and non-alcoholic beverages (except coffee, tea and cocoa)</b>
02 07 01	wastes from washing, cleaning and mechanical reduction of raw materials
02 07 02	wastes from spirits distillation
02 07 04	materials unsuitable for consumption or processing
<b>03</b>	<b>Wastes from wood processing and the production of panels and furniture, pulp, paper and cardboard</b>
<b>03 01</b>	<b>wastes from wood processing and the production of panels and furniture</b>
03 01 01	waste bark and cork
03 01 05	sawdust, shavings, cuttings, wood, particle board and veneer other than those mentioned in 03 01 04
<b>03 03</b>	<b>wastes from pulp, paper and cardboard production and processing</b>
03 03 01	waste bark and wood
03 03 07	mechanically separated rejects from pulping of waste paper and cardboard
03 03 08	wastes from sorting of paper and cardboard destined for recycling
03 03 10	fibre rejects, fibre-, filler- and coating-sludges from mechanical separation
<b>04</b>	<b>Wastes from the leather, fur and textile industries</b>
<b>04 01</b>	<b>wastes from the leather and fur industry</b>
04 01 08	waste tanned leather (blue sheetings, shavings, cuttings, buffing dust) containing chromium
04 01 09	wastes from dressing and finishing
<b>04 02</b>	<b>wastes from the textile industry</b>
04 02 21	wastes from unprocessed textile fibres
04 02 22	wastes from processed textile fibres
<b>06 09</b>	<b>wastes from the MSFU of phosphorous chemicals and phosphorous chemical processes</b>
06 09 02	phosphorous slag
06 09 04	calcium-based reaction wastes other than those mentioned in 06 09 03

<b>Table S2.1 Permitted waste types and quantities for transfer station</b>	
<b>Maximum quantity</b>	The total quantity of waste accepted at the site for the waste transfer and treatment and the waste drying activity shall be less than 75,000 tonnes a year.
<b>Exclusions</b>	Wastes having any of the following characteristics shall not be accepted: Consisting solely or mainly of dusts, powders or loose fibres. Wastes that are in a form which is either sludge or liquid.
<b>Waste code</b>	<b>Description</b>
<b>06 11</b>	<b>wastes from the manufacture of inorganic pigments and opacifiers</b>
06 11 01	calcium-based reaction wastes from titanium dioxide production
<b>07-02</b>	<b>wastes from the MFSU of plastics, synthetic rubber and man-made fibres</b>
07 02 13	waste plastic
<b>09</b>	<b>Wastes from the photographic industry</b>
<b>09 01</b>	<b>wastes from the photographic industry</b>
09 01 07	photographic film and paper containing silver or silver compounds
09 01 08	photographic film and paper free of silver or silver compounds
09 01 10	single-use cameras without batteries
09 01 12	single-use cameras containing batteries other than those mentioned in 09 01 11
<b>10</b>	<b>Wastes from thermal processes</b>
<b>10 01</b>	<b>wastes from power stations and other combustion plants (except 19)</b>
10 01 01	bottom ash, slag and boiler dust (excluding boiler dust mentioned in 10 01 04)
10 01 05	calcium-based reaction wastes from flue-gas desulphurisation in solid form
10 01 07	calcium-based reaction wastes from flue-gas desulphurisation in sludge form
10 01 15	bottom ash, slag and boiler dust from co-incineration other than those mentioned in 10 01 14
10 01 19	wastes from gas cleaning other than those mentioned in 10 01 05, 10 01 07 and 10 01 18
10 01 24	sands from fluidised beds
<b>10 02</b>	<b>wastes from the iron and steel industry</b>
10 02 01	wastes from the processing of slag
10 02 02	unprocessed slag
10 02 08	solid wastes from gas treatment other than those mentioned in 10 02 07
10 02 10	mill scales
10 02 14	sludges and filter cakes from gas treatment other than those mentioned in 10 02 13
10 02 15	other sludges and filter cakes
<b>10 03</b>	<b>wastes from aluminium thermal metallurgy</b>
10 03 02	anode scraps
10 03 05	waste alumina
10 03 16	skimmings other than those mentioned in 10 03 15
10 03 18	carbon-containing wastes from anode manufacture other than those mentioned in 10 03 17

<b>Table S2.1 Permitted waste types and quantities for transfer station</b>	
<b>Maximum quantity</b>	<b>The total quantity of waste accepted at the site for the waste transfer and treatment and the waste drying activity shall be less than 75,000 tonnes a year.</b>
<b>Exclusions</b>	<b>Wastes having any of the following characteristics shall not be accepted: Consisting solely or mainly of dusts, powders or loose fibres. Wastes that are in a form which is either sludge or liquid.</b>
<b>Waste code</b>	<b>Description</b>
10 03 24	solid wastes from gas treatment other than those mentioned in 10 03 23
10 03 26	sludges and filter cakes from gas treatment other than those mentioned in 10 03 25
10 03 28	wastes from cooling-water treatment other than those mentioned in 10 03 27
10 03 30	wastes from treatment of salt slags and black drosses other than those mentioned in 10 03 29
<b>10 04</b>	<b>wastes from lead thermal metallurgy</b>
10 04 10	wastes from cooling-water treatment other than those mentioned in 10 04 09
<b>10 05</b>	<b>wastes from zinc thermal metallurgy</b>
10 05 01	slags from primary and secondary production
10 05 09	wastes from cooling-water treatment other than those mentioned in 10 05 08
10 05 11	dross and skimmings other than those mentioned in 10 05 10
<b>10 06</b>	<b>wastes from copper thermal metallurgy</b>
10 06 01	slags from primary and secondary production
10 06 02	dross and skimmings from primary and secondary production
10 06 10	wastes from cooling-water treatment other than those mentioned in 10 06 09
<b>10 07</b>	<b>wastes from silver, gold and platinum thermal metallurgy</b>
10 07 01	slags from primary and secondary production
10 07 02	dross and skimmings from primary and secondary production
10 07 03	solid wastes from gas treatment
10 07 05	sludges and filter cakes from gas treatment
10 07 08	wastes from cooling-water treatment other than those mentioned in 10 07 07
<b>10 08</b>	<b>wastes from other non-ferrous thermal metallurgy</b>
10 08 09	other slags
10 08 11	dross and skimmings other than those mentioned in 10 08 10
10 08 13	carbon-containing wastes from anode manufacture other than those mentioned in 10 08 12
10 08 14	anode scrap
10 08 18	sludges and filter cakes from flue-gas treatment other than those mentioned in 10 08 17
10 08 20	wastes from cooling-water treatment other than those mentioned in 10 08 19
<b>10 09</b>	<b>wastes from casting of ferrous pieces</b>
10 09 03	furnace slag
10 09 06	casting cores and moulds which have not undergone pouring other than those mentioned in 10 09 05

<b>Table S2.1 Permitted waste types and quantities for transfer station</b>	
<b>Maximum quantity</b>	The total quantity of waste accepted at the site for the waste transfer and treatment and the waste drying activity shall be less than 75,000 tonnes a year.
<b>Exclusions</b>	Wastes having any of the following characteristics shall not be accepted: Consisting solely or mainly of dusts, powders or loose fibres. Wastes that are in a form which is either sludge or liquid.
<b>Waste code</b>	<b>Description</b>
10 09 08	casting cores and moulds which have undergone pouring other than those mentioned in 10 09 07
10 09 14	waste binders other than those mentioned in 10 09 13
10 09 16	waste crack-indicating agent other than those mentioned in 10 09 15
<b>10 10</b>	<b>wastes from casting of non-ferrous pieces</b>
10 10 03	furnace slag
10 10 06	casting cores and moulds which have not undergone pouring, other than those mentioned in 10 10 05
10 10 08	casting cores and moulds which have undergone pouring, other than those mentioned in 10 10 07
10 10 14	waste binders other than those mentioned in 10 10 13
10 10 16	waste crack-indicating agent other than those mentioned in 10 10 15
<b>10 11</b>	<b>wastes from manufacture of glass and glass products</b>
10 11 03	waste glass-based fibrous materials
10 11 10	waste preparation mixture before thermal processing, other than those mentioned in 10 11 09
10 11 12	waste glass other than those mentioned in 10 11 11
10 11 16	solid wastes from flue-gas treatment other than those mentioned in 10 11 15
10 11 18	sludges and filter cakes from flue-gas treatment other than those mentioned in 10 11 17
<b>10 12</b>	<b>wastes from manufacture of ceramic goods, bricks, tiles and construction products</b>
10 12 01	waste preparation mixture before thermal processing
10 12 05	sludges and filter cakes from gas treatment
10 12 06	discarded moulds
10 12 08	waste ceramics, bricks, tiles and construction products (after thermal processing)
10 12 10	solid wastes from gas treatment other than those mentioned in 10 12 09
10 12 12	wastes from glazing other than those mentioned in 10 12 11
<b>10 13</b>	<b>wastes from manufacture of cement, lime and plaster and articles and products made from them</b>
10 13 01	waste preparation mixture before thermal processing
10 13 04	wastes from calcination and hydration of lime
10 13 07	sludges and filter cakes from gas treatment
10 13 10	wastes from asbestos-cement manufacture other than those mentioned in 10 13 09

**Table S2.1 Permitted waste types and quantities for transfer station**

<b>Maximum quantity</b>	<b>The total quantity of waste accepted at the site for the waste transfer and treatment and the waste drying activity shall be less than 75,000 tonnes a year.</b>
<b>Exclusions</b>	<b>Wastes having any of the following characteristics shall not be accepted: Consisting solely or mainly of dusts, powders or loose fibres. Wastes that are in a form which is either sludge or liquid.</b>
<b>Waste code</b>	<b>Description</b>
10 13 11	wastes from cement-based composite materials other than those mentioned in 10 13 09 and 10 13 10
10 13 13	solid wastes from gas treatment other than those mentioned in 10 13 12
10 13 14	waste concrete and concrete sludge
<b>11</b>	<b>Wastes from chemical surface treatment and coating of metals and other materials; non-ferrous hydro-metallurgy</b>
<b>11 01</b>	<b>wastes from chemical surface treatment and coating of metals and other materials (for example galvanic processes, zinc coating processes, pickling processes, etching, phosphating, alkaline degreasing, anodising)</b>
11 01 10	sludges and filter cakes other than those mentioned in 11 01 09
11 01 14	degreasing wastes other than those mentioned in 11 01 13
<b>11 02</b>	<b>wastes from non-ferrous hydrometallurgical processes</b>
11 02 03	wastes from the production of anodes for aqueous electrolytical processes
11 02 06	wastes from copper hydrometallurgical processes other than those mentioned in 11 02 05
<b>11 05</b>	<b>wastes from hot galvanising processes</b>
11 05 01	hard zinc
11 05 02	zinc ash
<b>12</b>	<b>Wastes from shaping and physical and mechanical surface treatment of metals and plastics</b>
<b>12.01</b>	<b>wastes from shaping and physical and mechanical surface treatment of metals and plastics</b>
12 01 01	ferrous metal filings and turnings
12 01 03	non-ferrous metal filings and turnings
12 01 05	plastics shavings and turnings
12 01 13	welding wastes
12 01 17	waste blasting material other than those mentioned in 12 01 16
12 01 21	spent grinding bodies and grinding materials other than those mentioned in 12 01 20
<b>15</b>	<b>Waste packaging, absorbents, wiping cloths, filter materials and protective clothing not otherwise specified</b>
<b>15 01</b>	<b>packaging (including separately collected municipal packaging waste)</b>
15 01 01	paper and cardboard packaging
15 01 02	plastic packaging
15 01 03	wooden packaging
15 01 04	metallic packaging

<b>Table S2.1 Permitted waste types and quantities for transfer station</b>	
<b>Maximum quantity</b>	<b>The total quantity of waste accepted at the site for the waste transfer and treatment and the waste drying activity shall be less than 75,000 tonnes a year.</b>
<b>Exclusions</b>	<b>Wastes having any of the following characteristics shall not be accepted: Consisting solely or mainly of dusts, powders or loose fibres. Wastes that are in a form which is either sludge or liquid.</b>
<b>Waste code</b>	<b>Description</b>
15 01 05	composite packaging
15 01 06	mixed packaging
15 01 07	glass packaging
15 01 09	textile packaging
<b>15 02</b>	<b>absorbents, filter materials, wiping cloths and protective clothing</b>
15 02 03	absorbents, filter materials, wiping cloths and protective clothing other than those mentioned in 15 02 02
<b>16</b>	<b>Wastes not otherwise specified in the list</b>
16 01	end-of-life vehicles from different means of transport (including off-road machinery) and wastes from dismantling of end-of-life vehicles and vehicle maintenance (except 13, 14, 16 06 and 16 08)
16 01 03	end-of-life tyres
<b>16 02</b>	<b>wastes from electrical and electronic equipment</b>
16 02 14	discarded equipment other than those mentioned in 16 02 09 to 16 02 13
16 02 16	components removed from discarded equipment other than those mentioned in 16 02 15
<b>16 03</b>	<b>off-specification batches and unused products</b>
16 03 04	inorganic wastes other than those mentioned in 16 03 03
16 03 06	organic wastes other than those mentioned in 16 03 05
<b>16 06</b>	<b>batteries and accumulators</b>
16 06 04	alkaline batteries (except 16 06 03)
16 06 05	other batteries and accumulators
<b>16 11</b>	<b>waste linings and refractories</b>
16 11 02	carbon-based linings and refractories from metallurgical processes others than those mentioned in 16 11 01
16 11 04	other linings and refractories from metallurgical processes other than those mentioned in 16 11 03
16 11 06	linings and refractories from non-metallurgical processes others than those mentioned in 16 11 05
<b>17</b>	<b>Construction and demolition wastes (including excavated soil from contaminated sites)</b>
17 01	<b>concrete, bricks, tiles and ceramics</b>
17 01 01	concrete
17 01 02	bricks
17 01 03	tiles and ceramics

<b>Table S2.1 Permitted waste types and quantities for transfer station</b>	
<b>Maximum quantity</b>	The total quantity of waste accepted at the site for the waste transfer and treatment and the waste drying activity shall be less than 75,000 tonnes a year.
<b>Exclusions</b>	<b>Wastes having any of the following characteristics shall not be accepted:</b> <b>Consisting solely or mainly of dusts, powders or loose fibres.</b> <b>Wastes that are in a form which is either sludge or liquid.</b>
<b>Waste code</b>	<b>Description</b>
17 01 07	mixtures of concrete, bricks, tiles and ceramics other than those mentioned in 17 01 06
<b>17 02</b>	<b>wood, glass and plastic</b>
17 02 01	wood
17 02 02	glass
17 02 03	plastic
<b>17 03</b>	<b>bituminous mixtures, coal tar and tarred products</b>
17 03 02	bituminous mixtures other than those mentioned in 17 03 01
<b>17 04</b>	<b>metals (including their alloys)</b>
17 04 01	copper, bronze, brass
17 04 02	aluminium
17 04 03	lead
17 04 04	zinc
17 04 05	iron and steel
17 04 06	tin
17 04 07	mixed metals
17 04 11	cables other than those mentioned in 17 04 10
<b>17 05</b>	<b>soil (including excavated soil from contaminated sites), stones and dredging spoil</b>
17 05 04	soil and stones other than those mentioned in 17 05 03
17 05 08	track ballast other than those mentioned in 17 05 07
<b>17 06</b>	<b>insulation materials and asbestos-containing construction materials</b>
17 06 04	insulation materials other than those mentioned in 17 06 01 and 17 06 03
<b>17 08</b>	<b>gypsum-based construction material</b>
17 08 02	gypsum-based construction materials other than those mentioned in 17 08 01
<b>17 09</b>	<b>other construction and demolition wastes</b>
17 09 04	mixed construction and demolition wastes other than those mentioned in 17 09 01, 17 09 02 and 17 09 03
<b>19</b>	<b>Wastes from waste management facilities, off-site waste water treatment plants and the preparation of water intended for human consumption and water for industrial use</b>
<b>19 01</b>	<b>wastes from incineration or pyrolysis of waste</b>
19 01 02	ferrous materials removed from bottom ash
19 01 12	bottom ash and slag other than those mentioned in 19 01 11

<b>Table S2.1 Permitted waste types and quantities for transfer station</b>	
<b>Maximum quantity</b>	<b>The total quantity of waste accepted at the site for the waste transfer and treatment and the waste drying activity shall be less than 75,000 tonnes a year.</b>
<b>Exclusions</b>	<b>Wastes having any of the following characteristics shall not be accepted: Consisting solely or mainly of dusts, powders or loose fibres. Wastes that are in a form which is either sludge or liquid.</b>
<b>Waste code</b>	<b>Description</b>
19 01 18	pyrolysis wastes other than those mentioned in 19 01 17
19 01 19	sands from fluidised beds
<b>19 02</b>	<b>wastes from physico/chemical treatments of waste (including dechromatation, decyanidation, neutralisation)</b>
19 02 03	premixed wastes composed only of non-hazardous wastes
19 02 10	combustible wastes other than those mentioned in 19 02 08 and 19 02 09
<b>19 04</b>	<b>vitrified waste and wastes from vitrification</b>
19 04 01	vitrified waste
<b>19 05</b>	<b>wastes from aerobic treatment of solid wastes</b>
19 05 01	non-composted fraction of municipal and similar wastes
19 05 02	non-composted fraction of animal and vegetable waste
19 05 03	off-specification compost
<b>19 12</b>	<b>wastes from the mechanical treatment of waste (for example sorting, crushing, compacting, pelletising) not otherwise specified</b>
19 12 01	paper and cardboard
19 12 02	ferrous metal
19 12 03	non-ferrous metal
19 12 04	plastic and rubber
19 12 05	glass
19 12 07	wood other than that mentioned in 19 12 06
19 12 08	textiles
19 12 09	minerals (for example sand, stones)
19 12 10	combustible waste (refuse derived fuel)
<b>19 13</b>	<b>wastes from soil and groundwater remediation</b>
19 13 02	solid wastes from soil remediation other than those mentioned in 19 13 01
<b>20</b>	<b>Municipal wastes (household waste and similar commercial, industrial and institutional wastes) including separately collected fractions</b>
<b>20 01</b>	<b>separately collected fractions (except 15 01)</b>
20 01 01	paper and cardboard
20 01 02	glass
20 01 08	biodegradable kitchen and canteen waste
20 01 10	clothes
20 01 11	textiles

<b>Table S2.1 Permitted waste types and quantities for transfer station</b>	
<b>Maximum quantity</b>	<b>The total quantity of waste accepted at the site for the waste transfer and treatment and the waste drying activity shall be less than 75,000 tonnes a year.</b>
<b>Exclusions</b>	<b>Wastes having any of the following characteristics shall not be accepted: Consisting solely or mainly of dusts, powders or loose fibres. Wastes that are in a form which is either sludge or liquid.</b>
<b>Waste code</b>	<b>Description</b>
20 01 34	batteries and accumulators other than those mentioned in 20 01 33
20 01 36	discarded electrical and electronic equipment other than those mentioned in 20 01 21, 20 01 23 and 20 01 35
20 01 38	wood other than that mentioned in 20 01 37
20 01 39	plastics
20 01 40	metals
20 01 41	wastes from chimney sweeping
<b>20 02</b>	<b>garden and park wastes (including cemetery waste)</b>
20 02 01	biodegradable waste
20 02 02	soil and stones
<b>20 03</b>	<b>other municipal wastes</b>
20 03 01	mixed municipal waste
20 03 02	waste from markets
20 03 03	street-cleaning residues
20 03 07	bulky waste

<b>Table S2.2 Permitted waste types and quantities for pre-treatment of waste for incineration or co-incineration</b>	
<b>Maximum quantity</b>	<b>The total quantity of waste accepted at the site for the waste transfer and treatment and the waste drying activity shall be less than 75,000 tonnes a year.</b>
<b>Exclusions</b>	<b>Wastes having any of the following characteristics shall not be accepted: Consisting solely or mainly of dusts, powders or loose fibres. Wastes that are in a form which is either sludge or liquid.</b>
<b>Waste code</b>	<b>Description</b>
<b>02</b>	<b>Wastes from agriculture, horticulture, aquaculture, forestry, hunting and fishing, food preparation and processing</b>
02 01	wastes from agriculture, horticulture, aquaculture, forestry, hunting and fishing
02 01 03	plant-tissue waste
02 01 07	wastes from forestry
<b>03</b>	<b>Wastes from wood processing and the production of panels and furniture, pulp, paper and cardboard</b>
03 01	wastes from wood processing and the production of panels and furniture

**Table S2.2 Permitted waste types and quantities for pre-treatment of waste for incineration or co-incineration**

<b>Maximum quantity</b>	<b>The total quantity of waste accepted at the site for the waste transfer and treatment and the waste drying activity shall be less than 75,000 tonnes a year.</b>
<b>Exclusions</b>	<b>Wastes having any of the following characteristics shall not be accepted: Consisting solely or mainly of dusts, powders or loose fibres. Wastes that are in a form which is either sludge or liquid.</b>
<b>Waste code</b>	<b>Description</b>
03 01 05	sawdust, shavings, cuttings, wood, particle board and veneer other than those mentioned in 03 01 04
<b>03 03</b>	<b>wastes from pulp, paper and cardboard production and processing</b>
03 03 01	waste bark and wood
<b>15</b>	<b>Waste packaging, absorbents, wiping cloths, filter materials and protective clothing not otherwise specified</b>
15 01	packaging (including separately collected municipal packaging waste)
15 01 03	wooden packaging
<b>17</b>	<b>Construction and demolition wastes (including excavated soil from contaminated sites)</b>
<b>17 02</b>	<b>wood, glass and plastic</b>
17 02 01	wood
<b>19</b>	<b>Wastes from waste management facilities, off-site waste water treatment plants and the preparation of water intended for human consumption and water for industrial use</b>
<b>19 12</b>	<b>wastes from the mechanical treatment of waste (for example sorting, crushing, compacting, pelletising) not otherwise specified</b>
19 12 07	wood other than that mentioned in 19 12 06
<b>20</b>	<b>Municipal wastes (household waste and similar commercial, industrial and institutional wastes) including separately collected fractions</b>
<b>20 01</b>	<b>separately collected fractions (except 15 01)</b>
20 01 38	wood other than that mentioned in 20 01 37
<b>20 02</b>	<b>garden and park wastes (including cemetery waste)</b>
20 02 01	biodegradable waste

## Schedule 3 – Emissions and monitoring

There are no emission limits or associated monitoring requirements.

## Schedule 4 – Reporting

There is no reporting under this schedule.

## Schedule 5 – Notification

These pages outline the information that the operator must provide.

Units of measurement used in information supplied under Part A and B requirements shall be appropriate to the circumstances of the emission. Where appropriate, a comparison should be made of actual emissions and authorised emission limits.

If any information is considered commercially confidential, it should be separated from non-confidential information, supplied on a separate sheet and accompanied by an application for commercial confidentiality under the provisions of the EP Regulations.

### Part A

Permit Number	
Name of operator	
Location of Facility	
Time and date of the detection	

**(a) Notification requirements for any malfunction, breakdown or failure of equipment or techniques, accident, or emission of a substance not controlled by an emission limit which has caused, is causing or may cause significant pollution**

**To be notified within 24 hours of detection**

Date and time of the event	
Reference or description of the location of the event	
Description of where any release into the environment took place	
Substances(s) potentially released	
Best estimate of the quantity or rate of release of substances	
Measures taken, or intended to be taken, to stop any emission	
Description of the failure or accident.	

**(b) Notification requirements for the breach of a limit**

**To be notified within 24 hours of detection unless otherwise specified below**

Emission point reference/ source	
Parameter(s)	
Limit	
Measured value and uncertainty	
Date and time of monitoring	

<b>(b) Notification requirements for the breach of a limit</b>	
<b>To be notified within 24 hours of detection unless otherwise specified below</b>	
Measures taken, or intended to be taken, to stop the emission	

<b>Time periods for notification following detection of a breach of a limit</b>	
<b>Parameter</b>	<b>Notification period</b>

<b>(c) Notification requirements for the detection of any significant adverse environmental effect</b>	
<b>To be notified within 24 hours of detection</b>	
Description of where the effect on the environment was detected	
Substances(s) detected	
Concentrations of substances detected	
Date of monitoring/sampling	

## Part B – to be submitted as soon as practicable

Any more accurate information on the matters for notification under Part A.	
Measures taken, or intended to be taken, to prevent a recurrence of the incident	
Measures taken, or intended to be taken, to rectify, limit or prevent any pollution of the environment which has been or may be caused by the emission	
The dates of any unauthorised emissions from the facility in the preceding 24 months.	

<b>Name*</b>	
<b>Post</b>	
<b>Signature</b>	
<b>Date</b>	

\* authorised to sign on behalf of the operator

## Schedule 6 – Interpretation

“accident” means an accident that may result in pollution.

“Annex I” means Annex I to Directive 2008/98/EC of the European Parliament and of the Council on waste.

“Annex II” means Annex II to Directive 2008/98/EC of the European Parliament and of the Council on waste.

“application” means the application for this permit, together with any additional information supplied by the operator as part of the application and any response to a notice served under Schedule 5 to the EP Regulations.

“authorised officer” means any person authorised by the Environment Agency under section 108(1) of The Environment Act 1995 to exercise, in accordance with the terms of any such authorisation, any power specified in section 108(4) of that Act.

“building” means a construction that has the objective of providing sheltering cover and minimising emissions of noise, particulate matter, odour and litter.

“D” means a disposal operation provided for in Annex I to Directive 2008/98/EC of the European Parliament and of the Council on waste.

“emissions to land” includes emissions to groundwater.

“emissions of substances not controlled by emission limits” means emissions of substances to air, water or land from the activities, either from the emission points specified in schedule 3 or from other localised or diffuse sources, which are not controlled by an emission or background concentration limit.

“EP Regulations” means The Environmental Permitting (England and Wales) Regulations SI 2016 No.1154 and words and expressions used in this permit which are also used in the Regulations have the same meanings as in those Regulations.

“groundwater” means all water, which is below the surface of the ground in the saturation zone and in direct contact with the ground or subsoil.

“Hazardous waste” has the meaning given in the Hazardous Waste (England and Wales) Regulations 2005 (as amended).

“Impermeable surface” means a surface or pavement constructed and maintained to a standard sufficient to prevent transmission of liquids beyond the pavement surface, and should be read in conjunction with the term “sealed drainage system” below.

“List of Wastes” means the list of wastes established by Commission Decision 2000/532/EC replacing Decision 94/3/EC establishing a list of wastes pursuant to Article 1(a) of Council Directive 75/442/EEC on waste and Council Decision 94/904/EC establishing a list of hazardous waste pursuant to Article 1(4) of Council Directive 91/689/EEC on hazardous waste, as amended from time to time.

“pests” means birds, vermin and insects.

“quarter” means a calendar year quarter commencing on 1 January, 1 April, 1 July or 1 October.

“R” means a recovery operation provided for in Annex II to Directive 2008/98/EC of the European Parliament and of the Council on waste.

“Sealed drainage system” in relation to an impermeable surface, means a drainage system with impermeable components which does not leak and which will ensure that:

- (a) No liquid will run off the surface otherwise than via the system;
- (b) Except where they may lawfully be discharged to foul sewer, all liquids entering the system are collected in a sealed sump.

“specified waste” means the following waste codes in Table 2.1: 01 01 01, 01 01 02, 01 04 08, 01 04 09, 01 04 13, 02 04 01, 10 11 12, 10 12 08, 10 13 14, 15 01 07, 17 01 01, 17 01 02, 17 01 03, 17 01 07, 17 02 02, 17 03 02, 17 05 04, 17 05 08, 19 12 05, 19 12 09 and 20 02 02.

“Waste code” means the six digit code referable to a type of waste in accordance with the List of Wastes and in relation to hazardous waste, includes the asterisk.

“Waste Framework Directive” or “WFD” means Waste Framework Directive 2008/98/EC of the European Parliament and of the Council on waste.

“year” means calendar year ending 31 December.

When the following terms appear in the waste code list in Schedule 2, table S2.1 for that table they have the meaning given below:

“hazardous substance” means a substance classified as hazardous as a consequence of fulfilling the criteria laid down in parts 2 to 5 of Annex I to Regulation (EC) No 1272/2008.

“heavy metal” means any compound of antimony, arsenic, cadmium, chromium (VI), copper, lead, mercury, nickel, selenium, tellurium, thallium and tin, as well as these materials in metallic form, as far as these are classified as hazardous substances.

“PCBs” means

- polychlorinated biphenyls
- polychlorinated terphenyls
- monomethyl-tetrachlorodiphenyl methane, Monomethyl-dichloro-diphenyl methane, Monomethyldibromo-diphenyl methane
- any mixture containing any of the above mentioned substances in a total of more than 0,005 %by weight.

“transition metals” means any of the following metals: any compound of scandium, vanadium, manganese, cobalt, copper, yttrium, niobium, hafnium, tungsten, titanium, chromium, iron, nickel, zinc, zirconium, molybdenum and tantalum, as well as these materials in metallic form, as far as these are classified as hazardous substances.

“stabilisation” means processes which change the hazardousness of the constituents in the waste and transform hazardous waste into non-hazardous waste.

“solidification” means processes which only change the physical state of the waste by using additives without changing the chemical properties of the waste.

“partly stabilised wastes” means wastes containing, after the stabilisation process, hazardous constituents which have not been changed completely into non-hazardous constituents and could be released into the environment in the short, middle or long term.

# Schedule 7 – Site plan

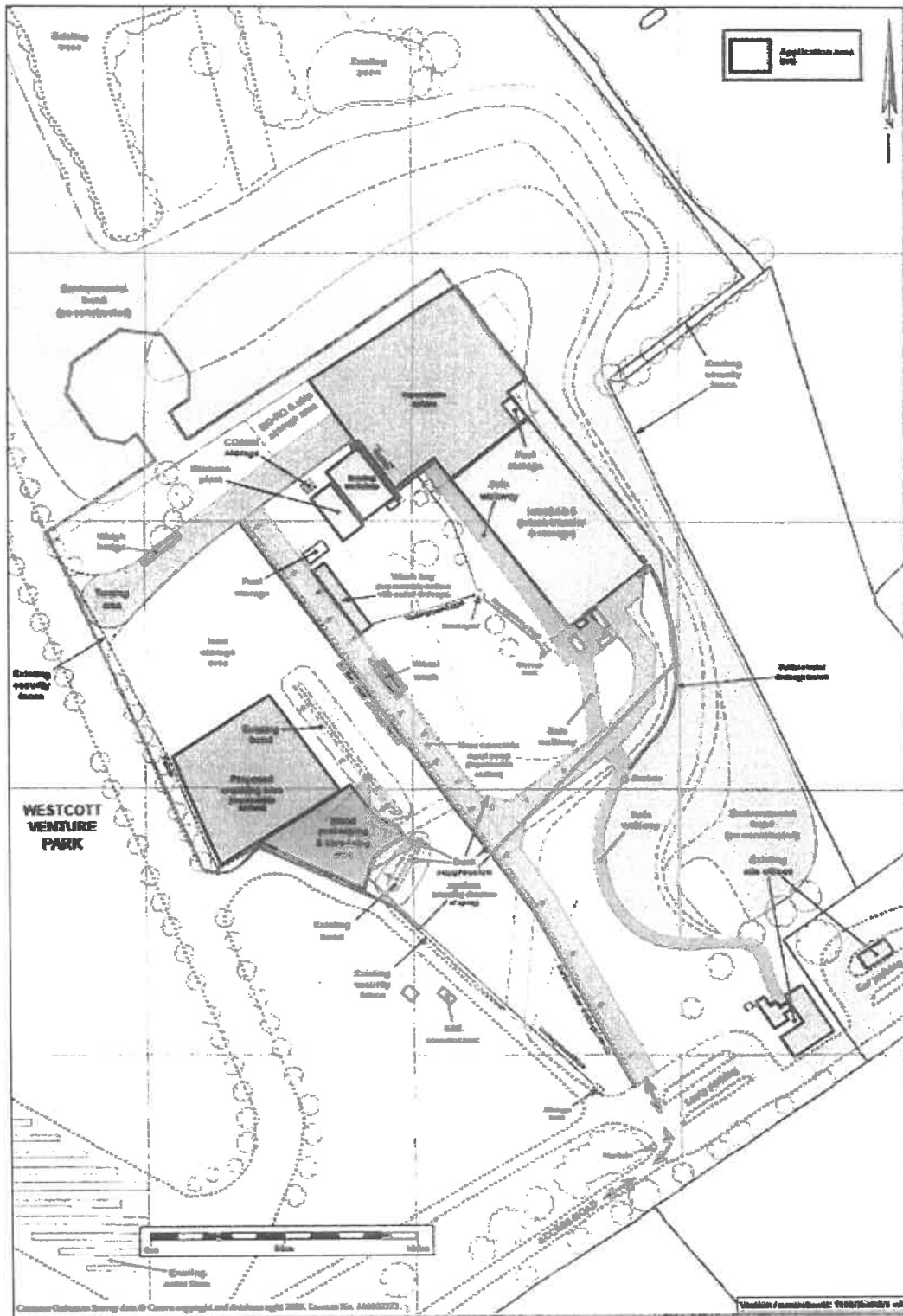

D.K. Spence Associates Site Plan Scale - 1:1,250 (at A3) Date - 21-01-2020 Plan No. 1116/W316/S3

©Crown Copyright. All rights reserved. Environment Agency, 100024198, 2020.

END OF PERMIT

Variation and consolidation  
 application number  
 EPR/BB3634RA/V004

**For the attention of The Company  
Director and/or Secretary**

**Date: 12/02/2020**

**Building 214 Westcott Venture Park  
Westcott  
Aylesbury  
Buckinghamshire  
HP18 0XB**

Dear Sir or Madam,

**Your permit variation is complete**

**Permit reference: EA/EPR/BB3634RA/V004**

**Waste returns reference: EAWML 103275**

**Operator: BUCKS RECYCLING LIMITED**

**Facility: Hangar 5**

Our determination of your application to vary your permit is complete. We're satisfied that you can continue to carry out your activities in accordance with the variation, without harm to the environment or human health. I enclose a notice showing the changes to your permit. Please keep this in a safe place with your other permit records.

This letter contains web links to other documents. If you aren't able to access these phone our Customer Contact Centre for help on 03708 506 506.

If you're not familiar with our guidance on how to comply with your permit please look at the following guides:

[www.gov.uk/guidance/develop-a-management-system-environmental-permits](http://www.gov.uk/guidance/develop-a-management-system-environmental-permits)

[www.gov.uk/guidance/control-and-monitor-emissions-for-your-environmental-permit](http://www.gov.uk/guidance/control-and-monitor-emissions-for-your-environmental-permit)

[www.gov.uk/guidance/legal-operator-and-competence-requirements-environmental-permits](http://www.gov.uk/guidance/legal-operator-and-competence-requirements-environmental-permits)

Please look at the table below and note any of the information or actions that apply to your permit.

If...	then..
<p>the variation means you're now carrying out a waste operation or activity and need to submit quarterly waste returns on waste movements</p> <p><b>Note:</b> This does not apply to permits that only have stand alone water discharge or groundwater activities.</p>	<p>you can get the forms you need from our website <a href="https://www.gov.uk/government/collections/national-operator-waste-returns">https://www.gov.uk/government/collections/national-operator-waste-returns</a></p> <p>When you complete your return use the waste returns reference above.</p>
<p>you need to submit other returns</p>	<p>send these to your area office. Speak to your area officer to check local arrangements.</p>
<p>your variation has added an installation to your permit for the first time</p>	<p>we've enclosed the pollution inventory letter, notice and fact sheet.</p>

### **Rights of appeal**

If you're not happy with any permit condition that has been imposed by the variation you may appeal to the Secretary of State. If you want to appeal any condition imposed as a result of your application you must make your appeal no later than six months from the date of the variation notice. If you want to appeal any condition we've added as an Environment Agency initiated variation you must make your appeal no later than two months from the date of the notice.

Further information about making an appeal and the forms you will need are available from the Planning Inspectorate website or from the contact details below.

**Environment Appeals, Enforcement and Specialist case work division, The Planning Inspectorate, 3A Eagle Wing, Temple Quay House, 2 The Square, Temple Quay, Bristol, BS1 6PN.**

**Telephone: 0303 444 5584**

**Email: [environment.appeals@pins.qsi.gov.uk](mailto:environment.appeals@pins.qsi.gov.uk)**

You must send written notice of the appeal and the documents listed below to the Secretary of State to the Planning Inspectorate address above. At the same time you must send us a copy of the notice and documents to

**Victoria Douglass, Permitting Technical Specialist – Appeals, Environment Agency, National Permitting Service, Knutsford Road, Latchford, Warrington, WA4 1HT.**

**Telephone: 02 03 02 51094**

**Email : [victoria.douglass@environment-agency.gov.uk](mailto:victoria.douglass@environment-agency.gov.uk)**

The documents are:

- a statement of the grounds of appeal
- a copy of any relevant application
- a copy of any relevant environmental permit
- a copy of any relevant correspondence between the appellant and the regulator
- a copy of any decision or notice which is the subject matter of the appeal; and
- a statement indicating whether you wish the appeal to be in the form of a hearing or dealt with by way of written representations.

You may withdraw an appeal by notifying the Secretary of State in writing and sending a copy of that notification to us.

If you have any questions about this permit phone our Customer Contact Centre on 03708 506 506. They will put you in touch with a local regulatory officer.

Yours sincerely

**Mark Jeffries**

## Permitting Support Advisor